

PREVIOUS INSPECTION DOCUMENTATION
(FOR REFERENCE ONLY)

INSPECTION SCOPE AND MATERIAL ASSESSMENT

This survey was conducted to determine whether asbestos is present on interior and exterior areas of the buildings, in preparation for building demolition. The sampler's discretion was used for determining the number of samples to be taken of suspect ACM in each HA. The areas inspected for ACM included the interior (1st and 2nd Floors) and exterior (windows, doors, and roofs) of the building.

The inspection was characterized by observations of accessible areas. Suspect materials examined and quantified during the inspection included:

- Drywall, White
- Soundproof Panel
- Wall Panel
- Joint Compound
- Exterior Door and Window Frame Caulk
- Wall Plaster
- Vinyl Door Strip
- Vinyl Baseboard
- Stair Treads
- 12"x12" and 9"x9" Tile and Mastic
- Carpet Mastic
- Rolled Flooring and Mastic
- Concrete Floor Sealant
- Ceiling Tile and Acoustical Tile
- Pipe Insulation
- Wall Insulation
- Plenum Gasket
- Sink Coating
- Boiler Insulation
- Tar Paper
- Roofing Fabric
- Roofing Tar
- Roof Flashing Sealant
- Roofing and Gutter Caulk
- Brick Sealant
- Stucco
- Unknown source

INSPECTION RESULTS

Analytical results of the bulk samples collected indicate that the following materials contain greater than 1% asbestos and are considered ACM.

- Non-friable Green 12x12 Tile and Black Mastic – Rooms Aircrew Lounge, Utility Closet, 107, 107A, 122A, 122B, Hallway into 122B, 122C, Northwestern Entrance Hall, and Southwestern Entrance Hall
- Non-friable Beige 9x9 tile and Black Mastic – Utility Closet and 208
- Non-friable Gray Transite Wall Panel – Utility Closet and Room 208
- Non-friable Gray 12x12 Tile and Black Mastic – Room 107A and 122B
- Non-friable Red 12x12 Tile and Black Mastic – Base Weather Station Room, Weather Base Conference Room and 102A Utility
- Friable Dark Brown 12x12 Tile – Rooms 206 and 208
- Non-friable Black Floor Tile and Black Mastic - Room 208
- Unknown source

AREAS NOT ACCESSIBLE

Void Spaces within Walls and Ceilings: No destructive sampling was performed on concealed spaces on walls to access plenum or chases. Due to the nature and outcome of the materials sampled Tehama did not observe any “suspect” materials continuing into plenums, etc. Tehama cannot account for all plenums/void spaces that exist in these facilities without selected demolition of existing walls, floors, ceilings, etc. Tehama recommends periodic oversight during demolition in order to assess any hidden/unforeseen materials that might be revealed.

POLYCHLORINATED BIPHENYLS

Polychlorinated biphenyls (PCBs) are regulated pursuant to the United States Environmental Protection Agency Code of Federal Regulations (40 CFR 761) and the Toxic Substances Control Act (TSCA – 15 U.S.C. 2605).

These regulations require certain testing and reporting requirements to determine management, recycling and disposal options for PCBs. Please see the below table itemizing the number of assumed PCB-containing Fluorescent Lighting Ballasts:

Facility (Floor/Level)	Ballast Quantity
Building 35 – Floor 1	67
Building 35 – Floor 2	47
APPROX. TOTAL	114

UNIVERSAL WASTES

Universal Wastes (i.e., batteries, thermostats, lamps, mercury-containing equipment, and pesticides) are regulated pursuant to the EPA Universal Waste Requirements (40 CFR Part 273). Similarly, these sampling procedures may also be used to determine

disposal/management or clean-up options for Universal Wastes. Typical equipment that might contain universal wastes are emergency light batteries, CFC containing refrigerators, water fountains, mercury containing bulbs, thermostats and thermometers. Please see the below table itemizing the number of assumed universal wastes:

Facility (Floor/Level)	Fluorescent Bulbs	CFC Containing Equipment	Mercury Containing Equipment	Water Fountains	AC Units
Building 35 – Floor 1	134	0	0	1	3
Building 35 – Floor 2	94	0	0	1	1
TOTALS	228	0	0	2	4

At various locations within the building Tehama noted other wastes that could potentially be considered hazardous if disposed of incorrectly.

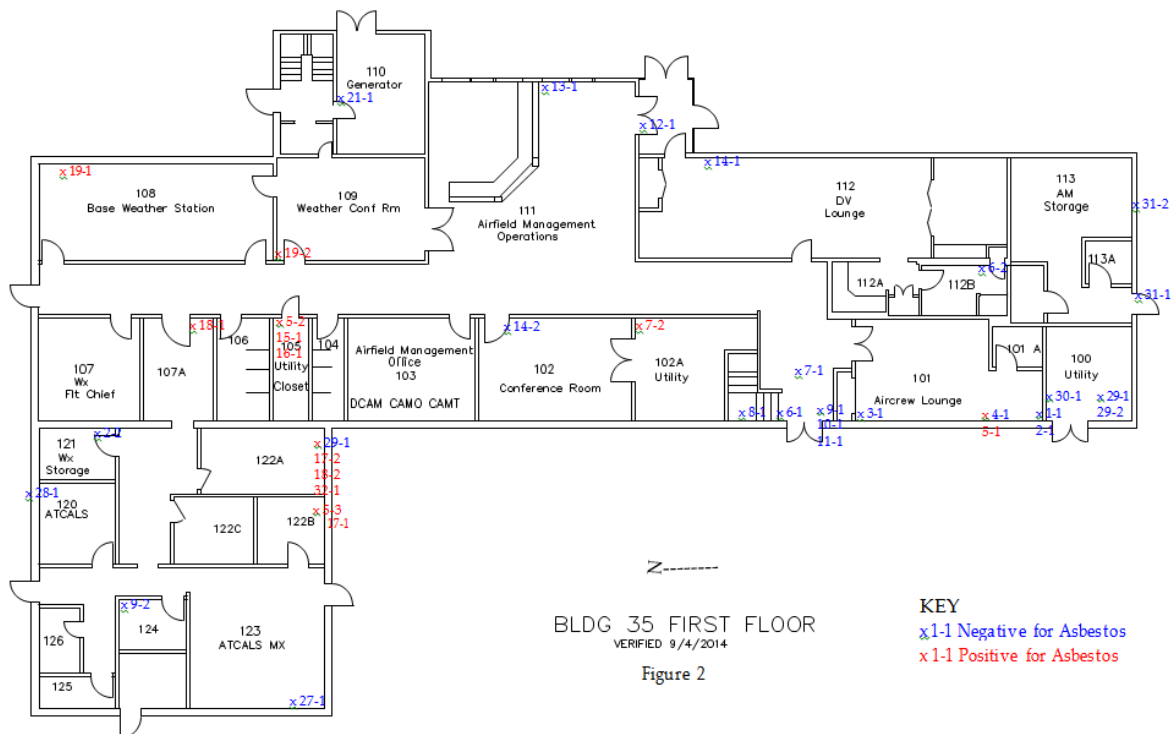

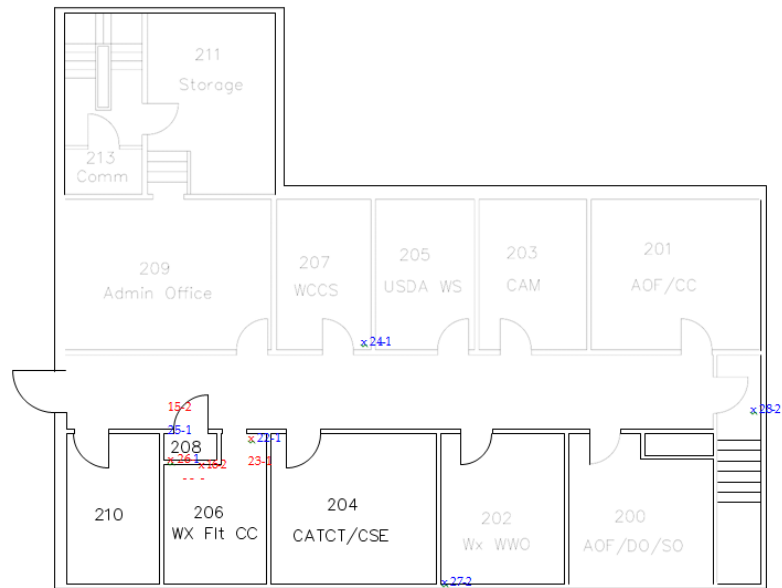

BLDG 35 SECOND FLOOR

KEY
x1-1 Negative for Asbestos
x1-1 Positive for Asbestos



Green 12x12 Tile located at Building 35 in Aircrew Lounge



Red 12x12 Tile located at Building 35 in 102A Utility



Beige and Green 12x12 Tile located at Building 35 in 105 Utility



Transite Wall Panel located at Building 35 in 105 Utility



Grey 12x12, Green 12x12, Plywood, and Green 12x12 Tile located at Building 35 in 122A



Beige and Very Dark Brown 12x12 Tile and Transite Wall located at Building 35 in 208



Red 12x12 Tile located at Building 35 in Base Weather Station and Weather Conference Room

END OF STATEMENT